

Jamestown Charter Township Master Plan Update Community Survey 2018

Introduction

Jamestown Charter Township is beginning the process of updating their Master Plan. The Master Plan is a document that helps guide land use decisions and future development within the Township. The Master Plan is typically updated every five (5) years and your help on this survey will guide us in the process. The survey will take about 15 minutes to complete.

Surveys must be completed by August 31, 2018.

This survey includes six (6) sections:

Section 1 – Quality of Community

Section 2 - Agricultural

Section 3 – Residential

Section 4 – Commercial and Industrial

Section 5 – Transportation

Section 6 – Your Information

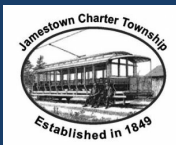

Jamestown Charter Township Master Plan Update Community Survey 2018

Section 1 - Quality of Community

1. Please rate Jamestown Charter Township as a place to live:

	Excellent	Good	Fair	Poor	I do not live in Jamestown Charter Township
Overall quality of life	<input type="radio"/>	<input type="radio"/>	<input type="radio"/>	<input type="radio"/>	<input type="radio"/>
Quality of your neighborhood	<input type="radio"/>	<input type="radio"/>	<input type="radio"/>	<input type="radio"/>	<input type="radio"/>
A place to raise children	<input type="radio"/>	<input type="radio"/>	<input type="radio"/>	<input type="radio"/>	<input type="radio"/>
A place to retire	<input type="radio"/>	<input type="radio"/>	<input type="radio"/>	<input type="radio"/>	<input type="radio"/>

2. Please rate each of the following characteristics in Jamestown Charter Township:

	Excellent	Good	Fair	Poor	No Opinion
Ease of travel	<input type="radio"/>	<input type="radio"/>	<input type="radio"/>	<input type="radio"/>	<input type="radio"/>
Availability of quality, affordable housing	<input type="radio"/>	<input type="radio"/>	<input type="radio"/>	<input type="radio"/>	<input type="radio"/>
Diverse housing options	<input type="radio"/>	<input type="radio"/>	<input type="radio"/>	<input type="radio"/>	<input type="radio"/>
Job opportunities	<input type="radio"/>	<input type="radio"/>	<input type="radio"/>	<input type="radio"/>	<input type="radio"/>
Access to health care facilities	<input type="radio"/>	<input type="radio"/>	<input type="radio"/>	<input type="radio"/>	<input type="radio"/>
Small town shopping opportunities	<input type="radio"/>	<input type="radio"/>	<input type="radio"/>	<input type="radio"/>	<input type="radio"/>
Good educational opportunities	<input type="radio"/>	<input type="radio"/>	<input type="radio"/>	<input type="radio"/>	<input type="radio"/>
Recreational opportunities	<input type="radio"/>	<input type="radio"/>	<input type="radio"/>	<input type="radio"/>	<input type="radio"/>

3. How would you characterize the overall rate of growth in Jamestown Charter Township?

- ☐ Too Fast
- ☐ About Right
- ☐ Too Slow

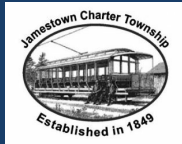

**Jamestown Charter Township
Master Plan Update
Community Survey
2018**

Section 2 - Agricultural

1. How important is it to preserve agricultural lands in Jamestown Charter Township?

- ☐ Extremely Important
- ☐ Somewhat Important
- ☐ Not Important

2. How important is it to preserve trees, vegetation, wildlife habitat, and other natural areas?

- ☐ Extremely Important
- ☐ Somewhat Important
- ☐ Not Important

3. The Township should support and promote private agricultural land conservation programs/initiatives.

☐ Strongly Agree

☐ Disagree

☐ Agree

☐ Strongly Disagree

☐ Neutral

4. Incentives, such as reducing minimum lot sizes, should be offered to developers that agree to provide a buffer area between residential developments and farmland.

☐ Strongly Agree

☐ Disagree

☐ Agree

☐ Strongly Disagree

☐ Neutral

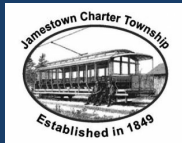

**Jamestown Charter Township
Master Plan Update
Community Survey
2018**

Section 3 - Residential

1. The Township should increase the amount of land dedicated for future single-family residential developments.

☐ Strongly Agree

☐ Disagree

☐ Agree

☐ Strongly Disagree

☐ Neutral

2. Which of the following images below (Image A or Image B) depict a more appealing residential development?

☐ Image A

☐ Image B

Image A

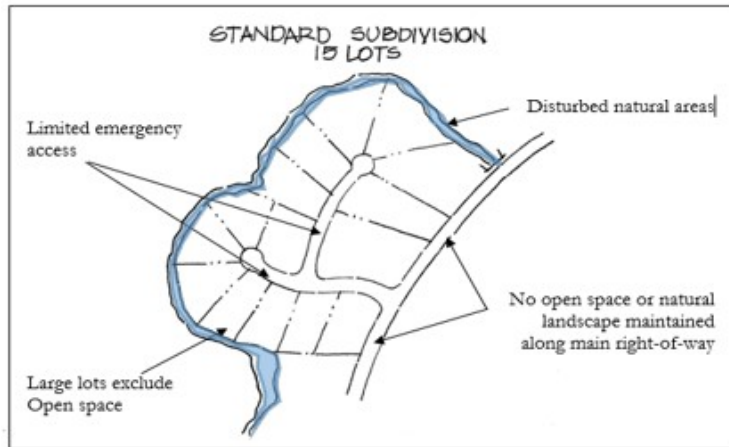

Image B



3. The Township should allow smaller lot sizes in residential developments only when there is dedicated open space, recreational areas, and/or common areas which are preserved for use by the residents of the development.

☐ Strongly Agree

☐ Disagree

☐ Agree

☐ Strongly Disagree

☐ Neutral

4. The Township should not allow smaller lot sizes and should maintain the current density limits within residential developments.

☐ Strongly Agree

☐ Disagree

☐ Agree

☐ Strongly Disagree

☐ Neutral

5. More multi-family residential developments (i.e. apartments and townhomes) are needed within the Township.

☐ Strongly Agree

☐ Disagree

☐ Agree

☐ Strongly Disagree

☐ Neutral

6. The existing multi-family developments in the Township are attractive and desirable.

☐ Strongly Agree

☐ Disagree

☐ Agree

☐ Strongly Disagree

☐ Neutral

7. What concerns, if any, do you have regarding the potential for new high density residential developments (check all that apply).

- ☐ Traffic congestion
- ☐ Tall buildings
- ☐ Visibility of parking lots
- ☐ Property conditions/maintenance
- ☐ Insufficient utilities
- ☐ Density is too high
- ☐ I have no concerns
- ☐ Other (please specify)

8. Multi-family residential developments should be required to have increased setbacks from property lines and landscape buffers around the development.

- | | |
|--------------------------------------|---|
| <input type="radio"/> Strongly Agree | <input type="radio"/> Disagree |
| <input type="radio"/> Agree | <input type="radio"/> Strongly Disagree |
| <input type="radio"/> Neutral | |

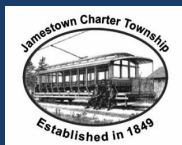

**Jamestown Charter Township
Master Plan Update
Community Survey
2018**

Section 4 - Commercial and Industrial

1. Please rank the desirability of each of the following commercial/mixed-use developments from 1 to 4, with 1 being the most desirable to 4 being the least desirable. See images below (Images A, B, C, and D).

	1 Most Desirable	2	3	4 Least Desirable
Image A	<input type="radio"/>	<input type="radio"/>	<input type="radio"/>	<input type="radio"/>
Image B	<input type="radio"/>	<input type="radio"/>	<input type="radio"/>	<input type="radio"/>
Image C	<input type="radio"/>	<input type="radio"/>	<input type="radio"/>	<input type="radio"/>
Image D	<input type="radio"/>	<input type="radio"/>	<input type="radio"/>	<input type="radio"/>

Image A



Image B



Image C



Image D



2. Please rank the desirability of each of the following industrial structures from 1 to 4, with 1 being the most desirable to 4 being the least desirable. See images below (Images A, B, C, and D).

	1 Most Desirable	2	3	4 Least Desirable
Image A	<input type="radio"/>	<input type="radio"/>	<input type="radio"/>	<input type="radio"/>
Image B	<input type="radio"/>	<input type="radio"/>	<input type="radio"/>	<input type="radio"/>
Image C	<input type="radio"/>	<input type="radio"/>	<input type="radio"/>	<input type="radio"/>
Image D	<input type="radio"/>	<input type="radio"/>	<input type="radio"/>	<input type="radio"/>

Image A



Image B



Image C



Image D



3. Mixed-use buildings (i.e. retail and office on street level and residential units above) should be permitted within the Township.

- ☐ Strongly Agree
- ☐ Agree
- ☐ Neutral

- ☐ Disagree
- ☐ Strongly Disagree

4. More businesses and services are desired in the Village of Jamestown.

- ☐ Strongly Agree
- ☐ Agree
- ☐ Neutral

- ☐ Disagree
- ☐ Strongly Disagree

5. More businesses and services are desired in Forest Grove.

- ☐ Strongly Agree
- ☐ Agree
- ☐ Neutral

- ☐ Disagree
- ☐ Strongly Disagree

6. More industries are desired in the Township.

☐ Strongly Agree

☐ Agree

☐ Neutral

☐ Disagree

☐ Strongly Disagree

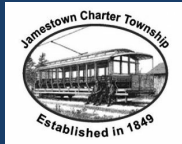

**Jamestown Charter Township
Master Plan Update
Community Survey
2018**

Section 5 - Transportation

1. The Township should invest in installing community gateways (signs, landscaping, other aesthetic features) along major access points into and out of the Township.

☐ Strongly Agree

☐ Agree

☐ Neutral

☐ Disagree

☐ Strongly Disagree

2. Please rate the importance of the following factors regarding roads and accessibility within the Township:

	Very Important	Important	Somewhat Important	Not Important
Paving gravel roads	<input type="radio"/>	<input type="radio"/>	<input type="radio"/>	<input type="radio"/>
Road maintenance	<input type="radio"/>	<input type="radio"/>	<input type="radio"/>	<input type="radio"/>
Addressing current road congestion	<input type="radio"/>	<input type="radio"/>	<input type="radio"/>	<input type="radio"/>
Reducing driveways/curb cuts along major roads	<input type="radio"/>	<input type="radio"/>	<input type="radio"/>	<input type="radio"/>
Driveways and/or parking areas of neighborhood businesses should be connected	<input type="radio"/>	<input type="radio"/>	<input type="radio"/>	<input type="radio"/>

3. Please rate the importance of the following factors regarding pedestrian facilities within the Township:

	Very Important	Important	Somewhat Important	Not Important
Adding new regional recreational trails (such as Fred Meijer Kenowa Trail)	<input type="radio"/>	<input type="radio"/>	<input type="radio"/>	<input type="radio"/>
Requiring sidewalks in all new residential neighborhoods	<input type="radio"/>	<input type="radio"/>	<input type="radio"/>	<input type="radio"/>
Maintaining existing sidewalk and trail network	<input type="radio"/>	<input type="radio"/>	<input type="radio"/>	<input type="radio"/>
Connecting gaps within the existing sidewalk and trail network	<input type="radio"/>	<input type="radio"/>	<input type="radio"/>	<input type="radio"/>
Adding bike lanes/paved shoulders along roads	<input type="radio"/>	<input type="radio"/>	<input type="radio"/>	<input type="radio"/>

4. If you could prioritize use of Township funds, how important is spending on each of the following items:

	Very Important	Important	Somewhat Important	Not Important
Paving gravel roads	<input type="radio"/>	<input type="radio"/>	<input type="radio"/>	<input type="radio"/>
Increasing capacity along major roads	<input type="radio"/>	<input type="radio"/>	<input type="radio"/>	<input type="radio"/>
Adding new regional recreational paths	<input type="radio"/>	<input type="radio"/>	<input type="radio"/>	<input type="radio"/>
Maintaining existing sidewalk and trail network	<input type="radio"/>	<input type="radio"/>	<input type="radio"/>	<input type="radio"/>
Connecting gaps within the existing sidewalk and trail network	<input type="radio"/>	<input type="radio"/>	<input type="radio"/>	<input type="radio"/>
Adding bike lanes/paved shoulders along roads	<input type="radio"/>	<input type="radio"/>	<input type="radio"/>	<input type="radio"/>

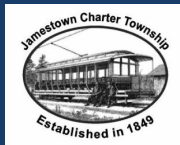

**Jamestown Charter Township
Master Plan Update
Community Survey
2018**

Section 6 - Your Information

1. What is your gender?

- ☐ Male
- ☐ Female
- ☐ Prefer not to answer

2. What is your age range?

- | | |
|--------------------------------------|--------------------------------------|
| <input type="radio"/> Under 17 years | <input type="radio"/> 45 to 54 years |
| <input type="radio"/> 18 to 24 years | <input type="radio"/> 55 to 64 years |
| <input type="radio"/> 25 to 34 years | <input type="radio"/> Over 65 years |
| <input type="radio"/> 35 to 44 years | |

3. What term best describes you?

- ☐ I live here
- ☐ I work here
- ☐ I own a business here
- ☐ I do not live, work or own a business here
- ☐ Other (please specify)

4. Using the map below, please indicate which quadrant you live, work or own a business in.

- | | |
|----------------------------------|---|
| <input type="radio"/> Quadrant 1 | <input type="radio"/> Quadrant 4 |
| <input type="radio"/> Quadrant 2 | <input type="radio"/> I do not live, work or own a business here. |
| <input type="radio"/> Quadrant 3 | |

Quadrant Map

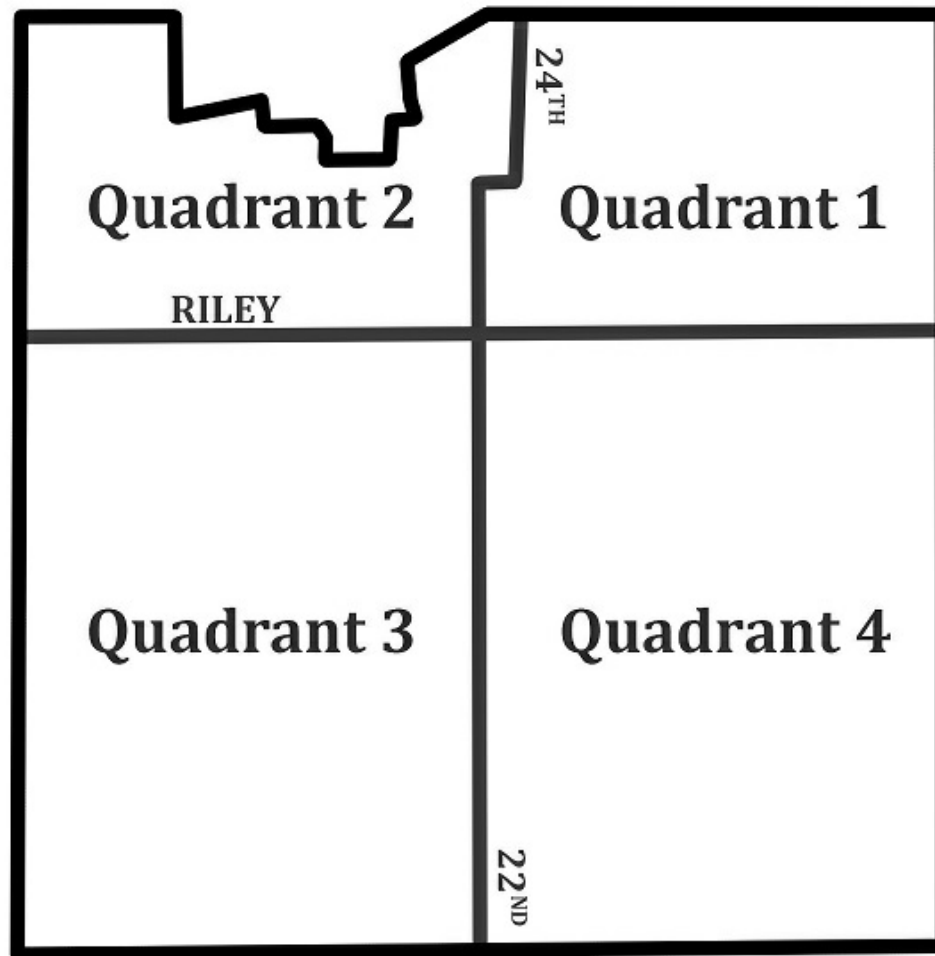

5. How long have you lived in Jamestown Charter Township?

- | | |
|--|---|
| <input type="radio"/> Less than 1 year | <input type="radio"/> 6 to 10 years |
| <input type="radio"/> 1 to 2 years | <input type="radio"/> 10 or more years |
| <input type="radio"/> 3 to 5 years | <input type="radio"/> I do not live in Jamestown Charter Township |

6. If you live in Jamestown Charter Township, what term best describes your residence?

- | | |
|---|---|
| <input type="radio"/> Single family home | <input type="radio"/> Mobile home (rented) |
| <input type="radio"/> Single family home (rented) | <input type="radio"/> Apartment |
| <input type="radio"/> Mobile home (owned) | <input type="radio"/> I do not live in Jamestown Charter Township |
| <input type="radio"/> Other (please specify) | |

7. Please feel free to add any comments you have about Jamestown Charter Township's future and master planning process in the space provided below.

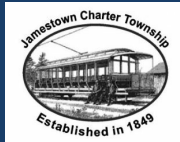

**Jamestown Charter Township
Master Plan Update
Community Survey
2018**

Thank you for your participation, we value your input!

For updates and information about the Master Plan, please be sure to visit the Jamestown Township Master Plan Facebook page at: <https://www.facebook.com/jamestownmp>

Please like or follow us to receive updates on progress, meetings, and other relevant information.

We also need your input on the Jamestown Township Parks & Recreation Plan!

The Township is in the process of developing a parks and recreation plan and is seeking your input. Please use the following link to complete this survey: <https://www.surveymonkey.com/r/jtparksrec>

